

## APPENDIX AA

### Millennial Campus Boundary Change – The University of North Carolina at Charlotte

The 2000 session of the General Assembly authorized the Board of Governors to designate a Millennial Campus at each constituent institution when the Board finds that such a designation will enhance the economic development of the region served by the constituent institution. The legislation states that the Board should act on the recommendation of the President after the President has consulted with the Chancellor and the Board of Trustees. The designation shall be based on the express finding that the institution has the administrative and fiscal capacity to create and maintain such a campus. Each Millennial Campus would function in a manner similar to the Centennial Campus at North Carolina State University and each would be exempt from the provisions of the Umstead Act.

The Board of Trustees of the University of North Carolina at Charlotte has requested that the Board of Governors approve the addition of the Smith Hall tract, approximately 1.5 acres of University-owned real property and appurtenant facilities, to become part of the existing UNCC Charlotte Research Institute (Millennial) Campus. The existing campus currently includes about 100 acres of land, consisting of a 16-acre parcel on the core campus, which includes Cameron Hall, Burson Hall, Health and Human Services, College of Education, and Woodward Hall and an 84-acre parcel adjoining Tryon Street on the north side of the University, which includes Grigg Hall and Duke Centennial Hall. Adding the Smith Hall Tract (as indicated on the attached) to the Millennial Campus will support additional partnerships involving engineering design, analysis, and testing; and will allow research partners in the Charlotte economic region to have flexible access to state of the art testing equipment and facilities that are housed in Smith Hall. In the near term, this addition will enable the creation of new partnerships between UNC Charlotte and private industry related to civil and environmental engineering while supporting the growth of collaborative research in energy production and infrastructure. In the long term, this action will also enable future collaborations as Smith Hall is renovated and repopulated with engineering and engineering technology faculty. The President and his staff have completed the required consultations and have found that the activities to be performed on the Millennial Campus would advance regional economic development and that the campus has the administrative and fiscal capacity that is required to successfully administer the program.

It is recommended that the findings of the President and his staff be accepted and the request of the Board of Trustees of UNC Charlotte be approved.

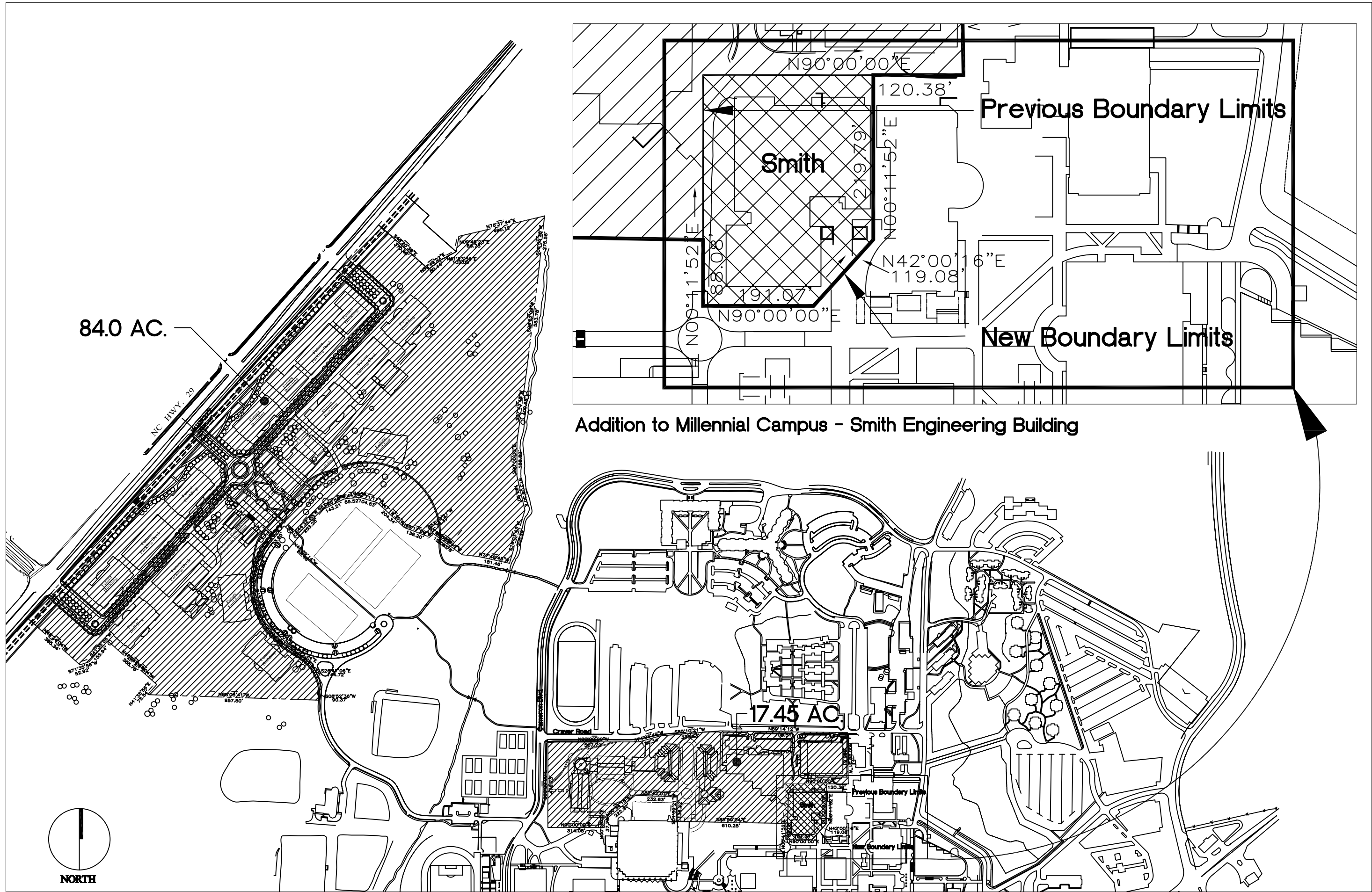

Rev: Add Smith Eng Building, 05/30/07

UNIVERSITY OF NORTH CAROLINA AT CHARLOTTE	PROJECT	MILLENNIAL CAMPUS AREA DELINEATION		FACILITIES PLANNING DEPARTMENT	
		SCALE 1"=500'	DATE 10/05/01	DWG. NO. CI 1.0	