

Millennial Campus Designation – The University of North Carolina at Wilmington

The 2000 session of the General Assembly authorized the Board of Governors to designate a Millennial Campus at each constituent institution when the Board finds that such a designation will enhance the economic development of the region served by the constituent institution. The legislation states that the Board should act on the recommendation of the President after the President has consulted with the Chancellor and the Board of Trustees. The designation should be based on the express finding that the institution has the administrative and fiscal capacity to create and maintain such a campus. Each Millennial Campus would function in a manner similar to the Centennial Campus at North Carolina State University and each would be exempt from the provisions of the Umstead Act.

The Board of Trustees of the University of North Carolina at Wilmington has requested that the Board of Governors designate as a Millennial Campus approximately 210 acres in three separate sites based on their proximity to existing campus academic and research activities (as indicated on the attached). The East site (47 acres) and the West site (103 acres) are located on the main campus. The South site (60 acres) is located on UNCW property about seven miles south of the main campus at the Center for Marine Science. The Millennial Campus, which will be known as CREST (Campus for Research, Entrepreneurship, Service, and Teaching) would be developed to enhance the research, teaching, and service missions of UNCW by relying on its respective strengths in Marine Biotechnology; Health, Fitness and Nutrition; and Chemistry, Biochemistry and Molecular Biology. The President and his staff have completed the required consultations and have found that the activities to be performed on the Millennial Campus would advance regional economic development and that the campus has the administrative and fiscal capacity that is required to successfully administer the program.

It is recommended that the findings of the President and his staff be accepted and the request of the Board of Trustees of UNC Wilmington be approved.

## **University of North Carolina at Wilmington Millennial Campus Property Description**

### **EAST CREST SITE**

The term East CREST Site comprises the following property:

The real property and appurtenant facilities bounded by the intersection of Walton Drive and Price Drive to proceed north along Walton Drive extended until reaching the northern property line, then proceeding in a westerly direction bounded by the northern property line until reaching Reynolds Drive, then proceeding in a southerly direction along Reynolds Drive to Price Drive, then proceeding east to the intersection of Price Drive and Walton Drive.

### **WEST CREST SITE**

The term West CREST Site comprises the following property:

The real property and appurtenant facilities bounded by the corner of MacMillan Avenue and College Road proceeding east along MacMillan Avenue to the intersection of Hamilton Drive, then proceeding along the southern property line to Riegel Road, then following Riegel Road until it intersects Hamilton Drive then extending Riegel Road through Lot A and Eaton Plaza to intersect with Wagoner Drive, then proceeding south on Wagoner Drive until reaching Hurst Drive, then west on Hurst Drive to the intersection of College Road, then proceeding south on College Road to the intersection with MacMillan Avenue.

### **SOUTH CREST SITE**

The term South Crest Site comprises the following property:

The real property and appurtenant facilities bounded by the corner of Masonboro Loop Road and Holt Road proceeding easterly along the irregular southern property line until reaching the Intracoastal Waterway, then proceeding in a northerly direction along the shoreline until reaching the northeastern property marker, then turning west and proceeding along the property line to its intersection with Masonboro Loop Road, then proceeding south along Masonboro Loop Road and ending at its intersection with Holt road. This is also listed in Book 1612 Page 0416 as recorded in the New Hanover Registrar of Deeds Office more commonly known as 5001 Masonboro Loop Road, Wilmington, N.C. 28409.

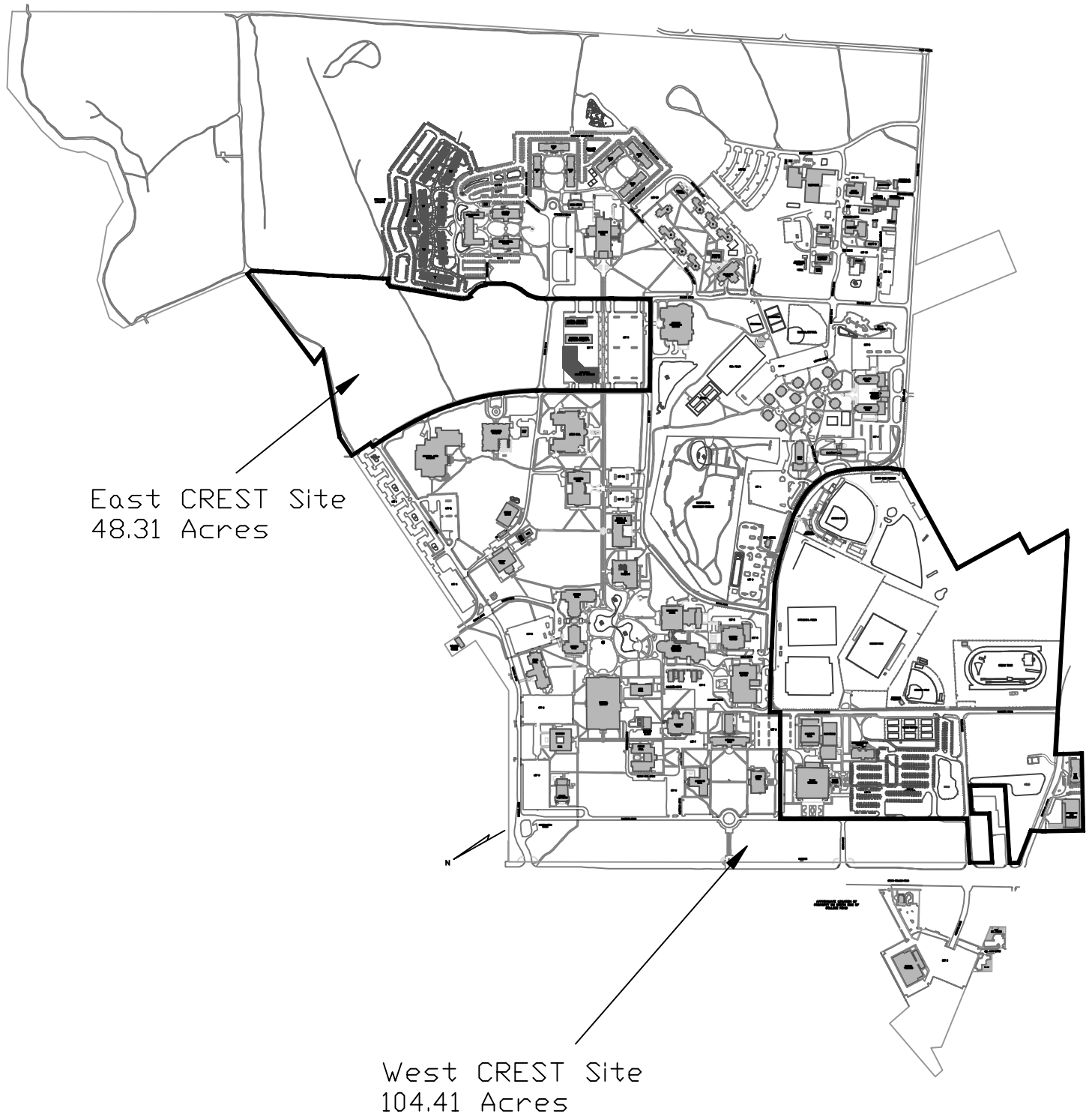

**UNCW**  
MILLENNIAL CAMPUS LOCATIONS  
Main Campus

05/30/07

South CREST Site  
57.44 Acres

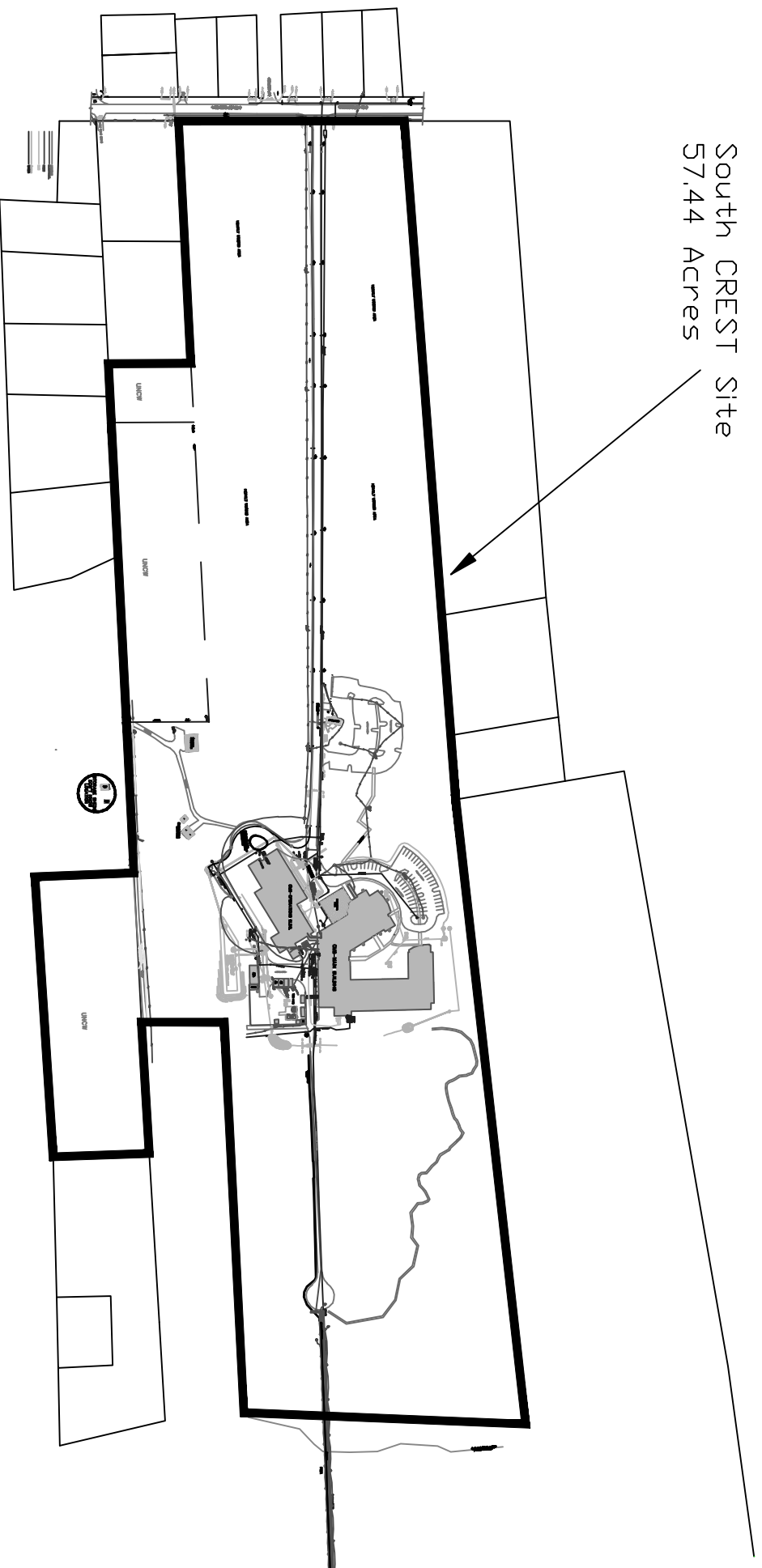

**UNCW**

MILLENNIAL CAMPUS LOCATION

CMS Campus

05/30/10